

## SCENARIO 1: FULL REPLACEMENT TO NORTH

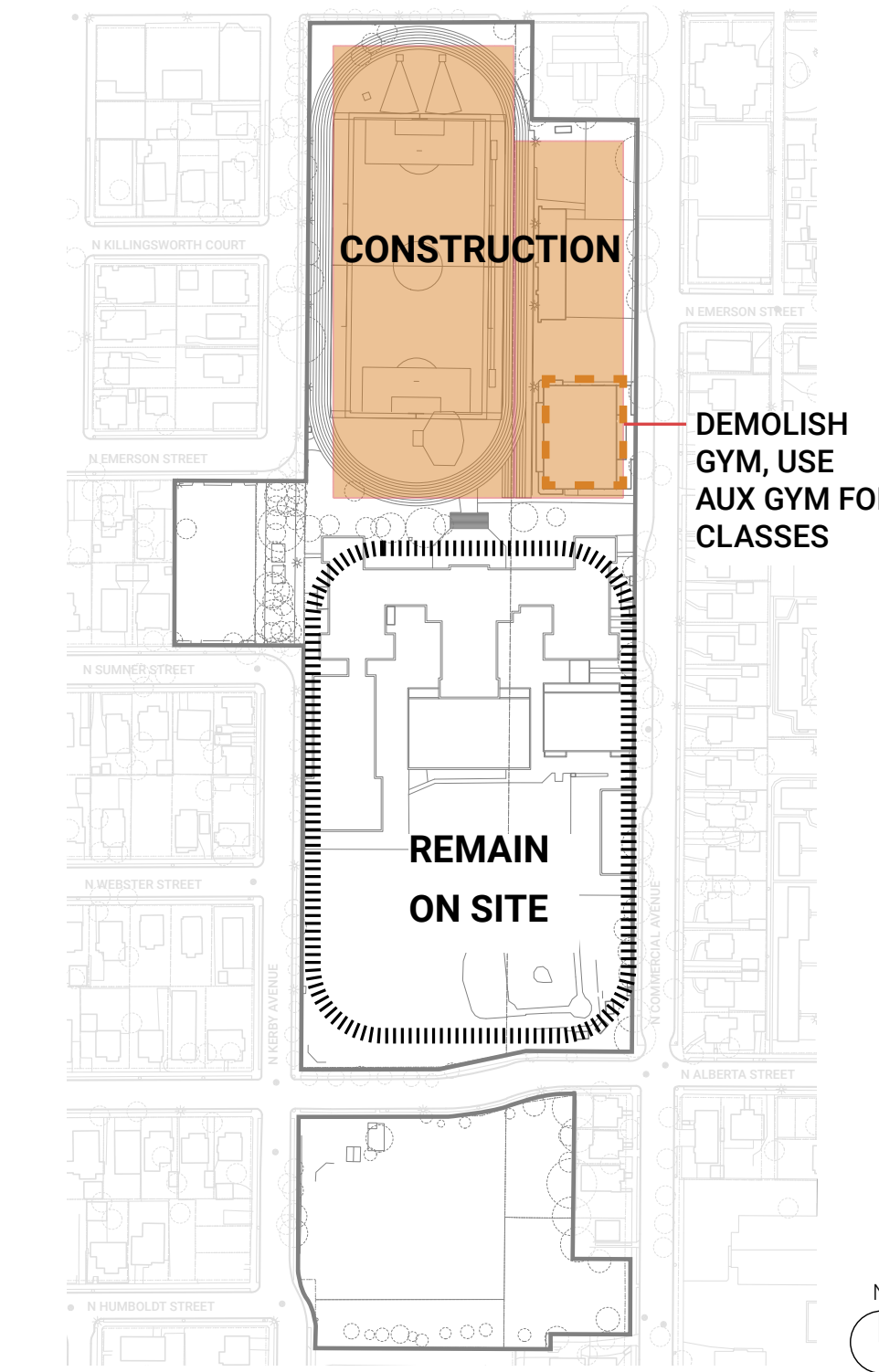
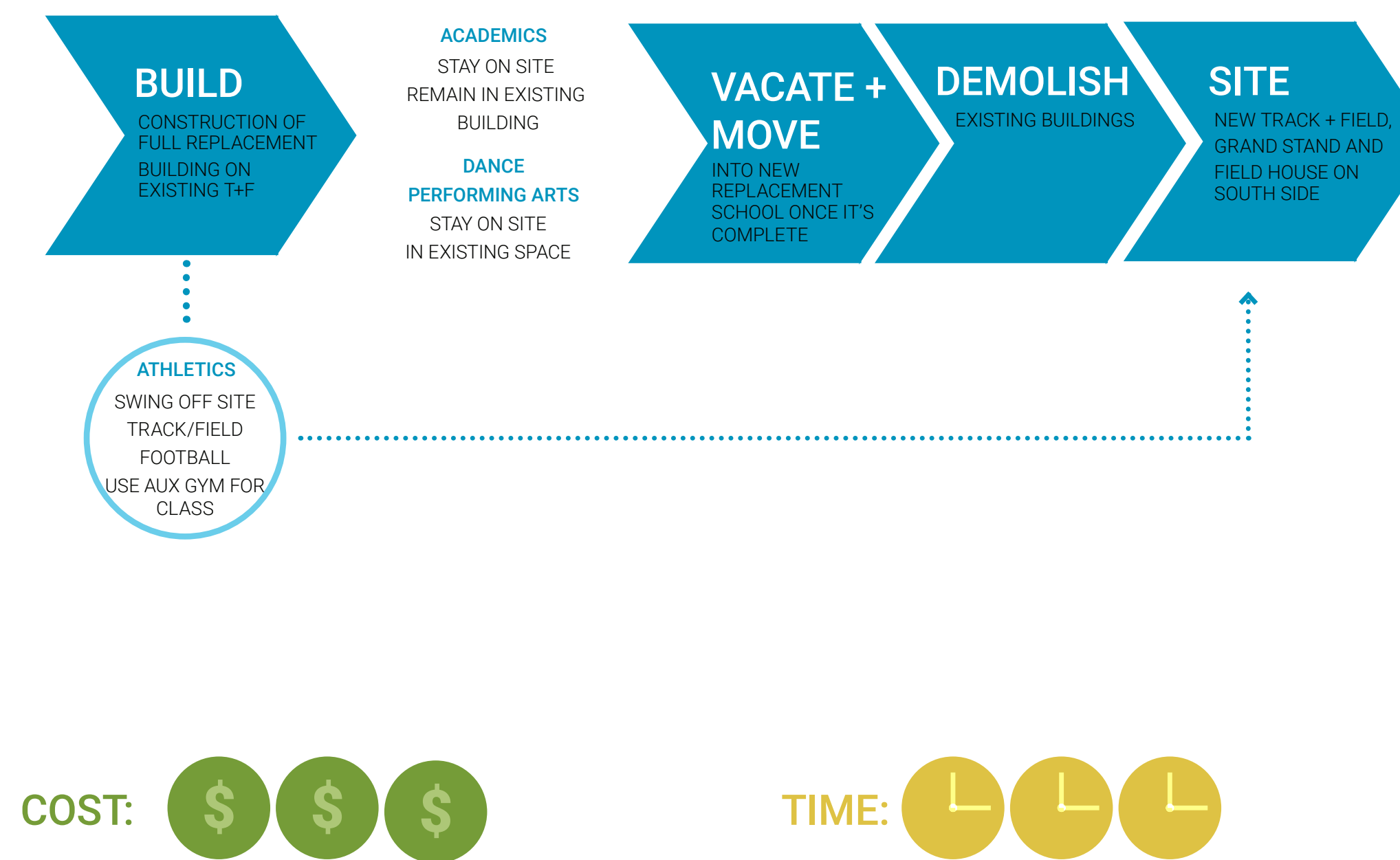
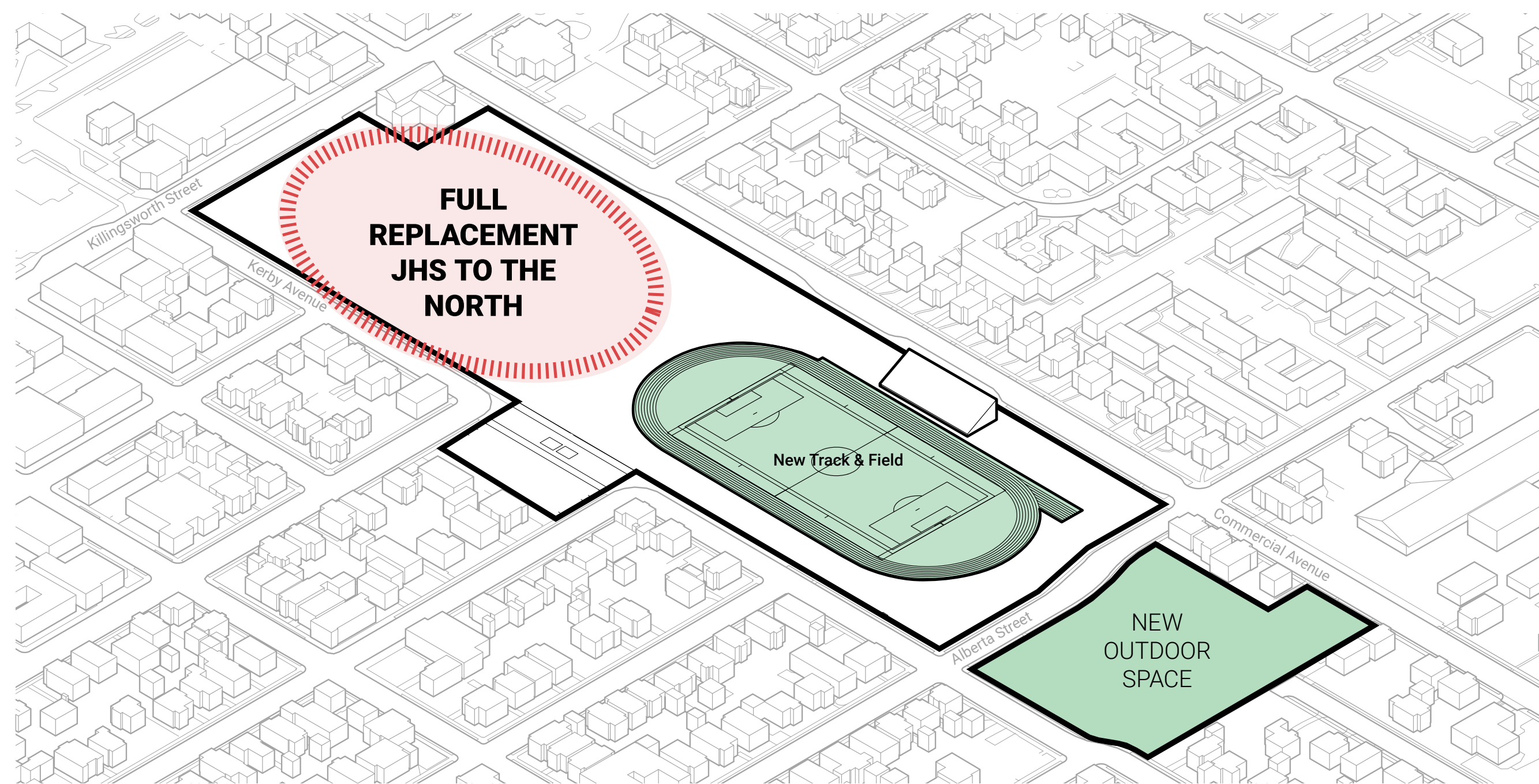

A full replacement building is constructed on the north end of the site. The track and field is re-constructed to the south.

Summary:

- Not very disruptive to academics and performing arts (students can remain in existing JHS building until new school in complete)
- Very disruptive to athletic spaces (students will need to swing off-site for athletics)
- Fastest project delivery timeline
- New construction is less expensive

## SCENARIO 2: FULL REPLACEMENT TO SOUTH

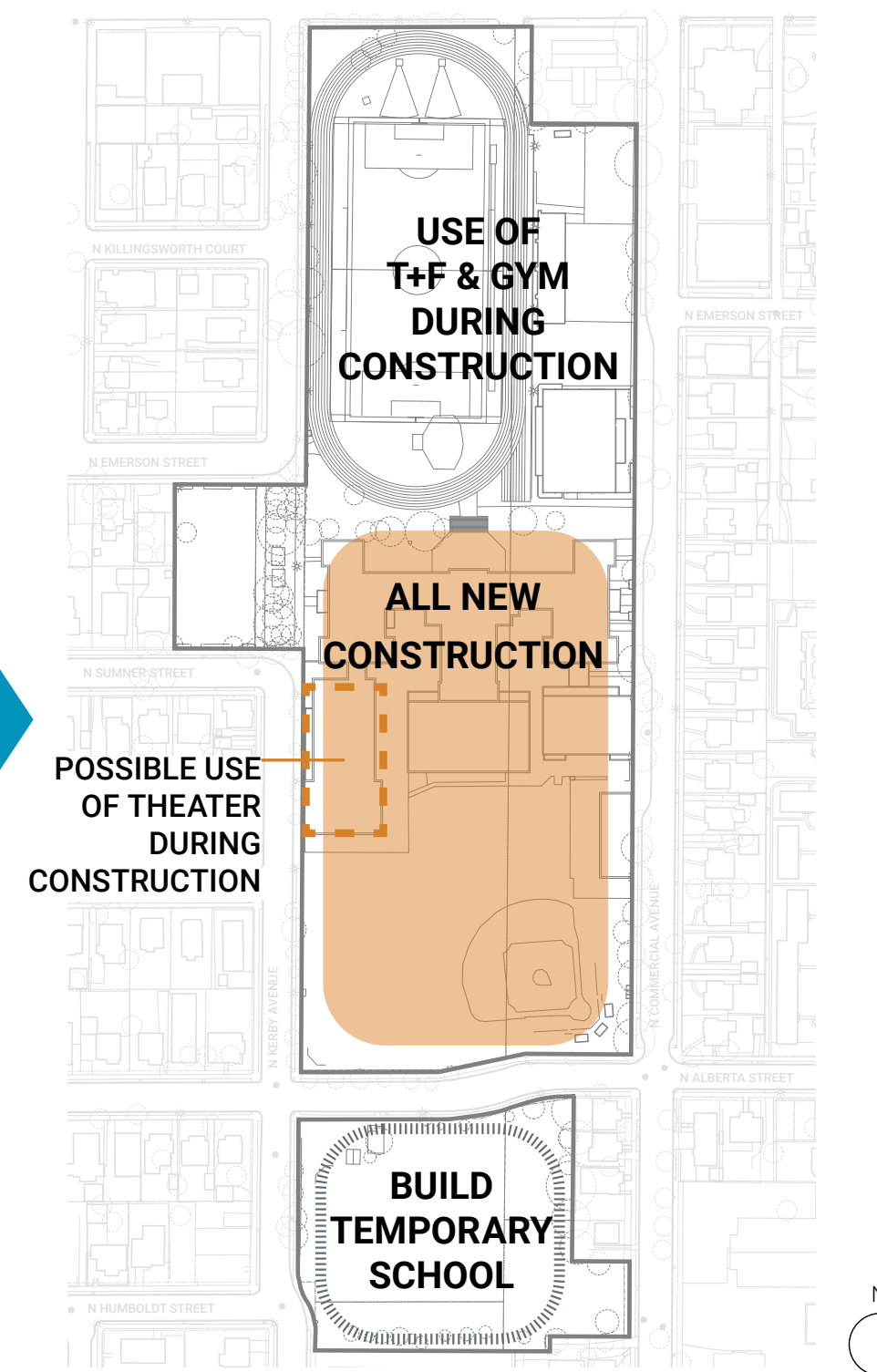
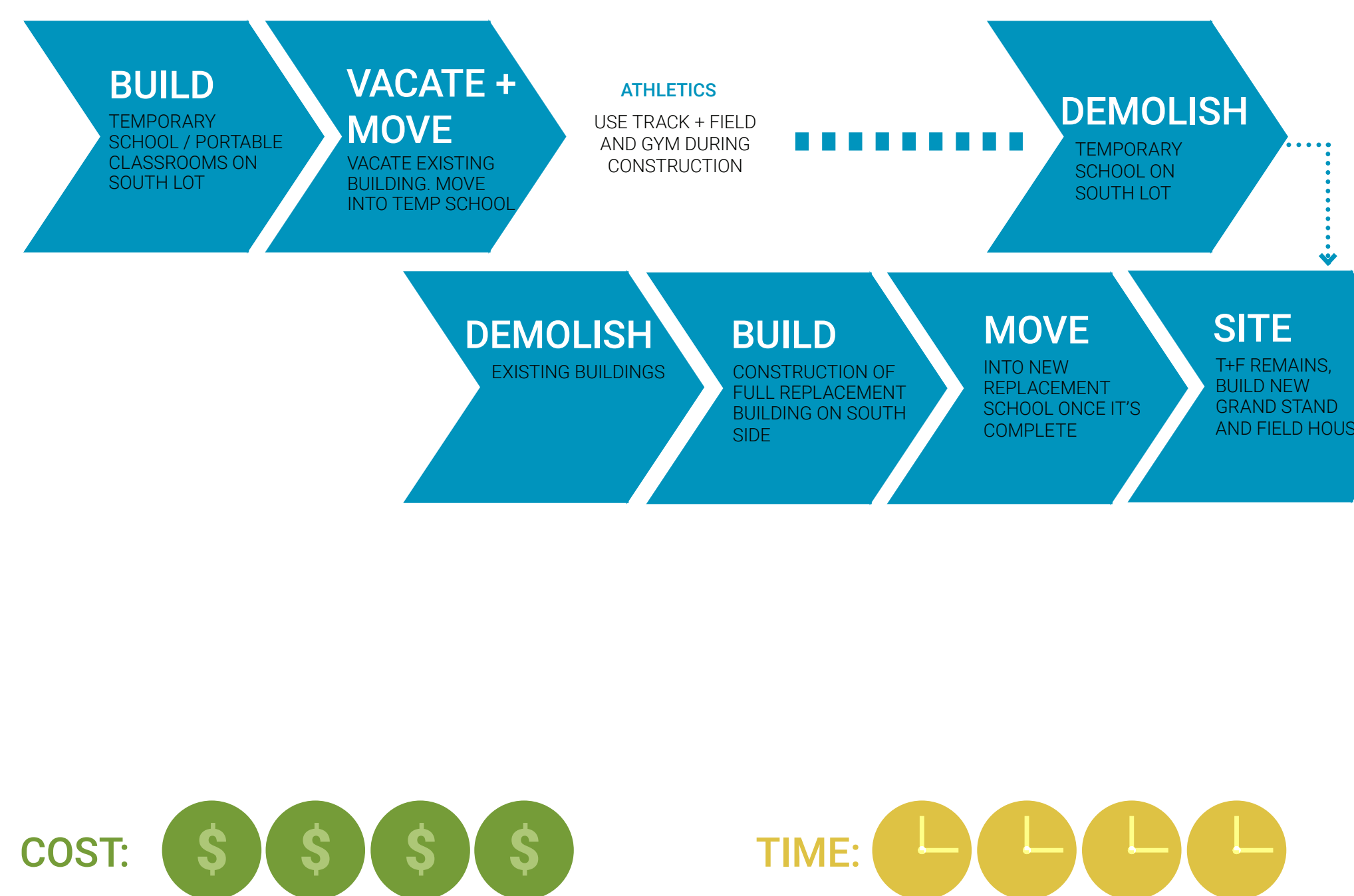
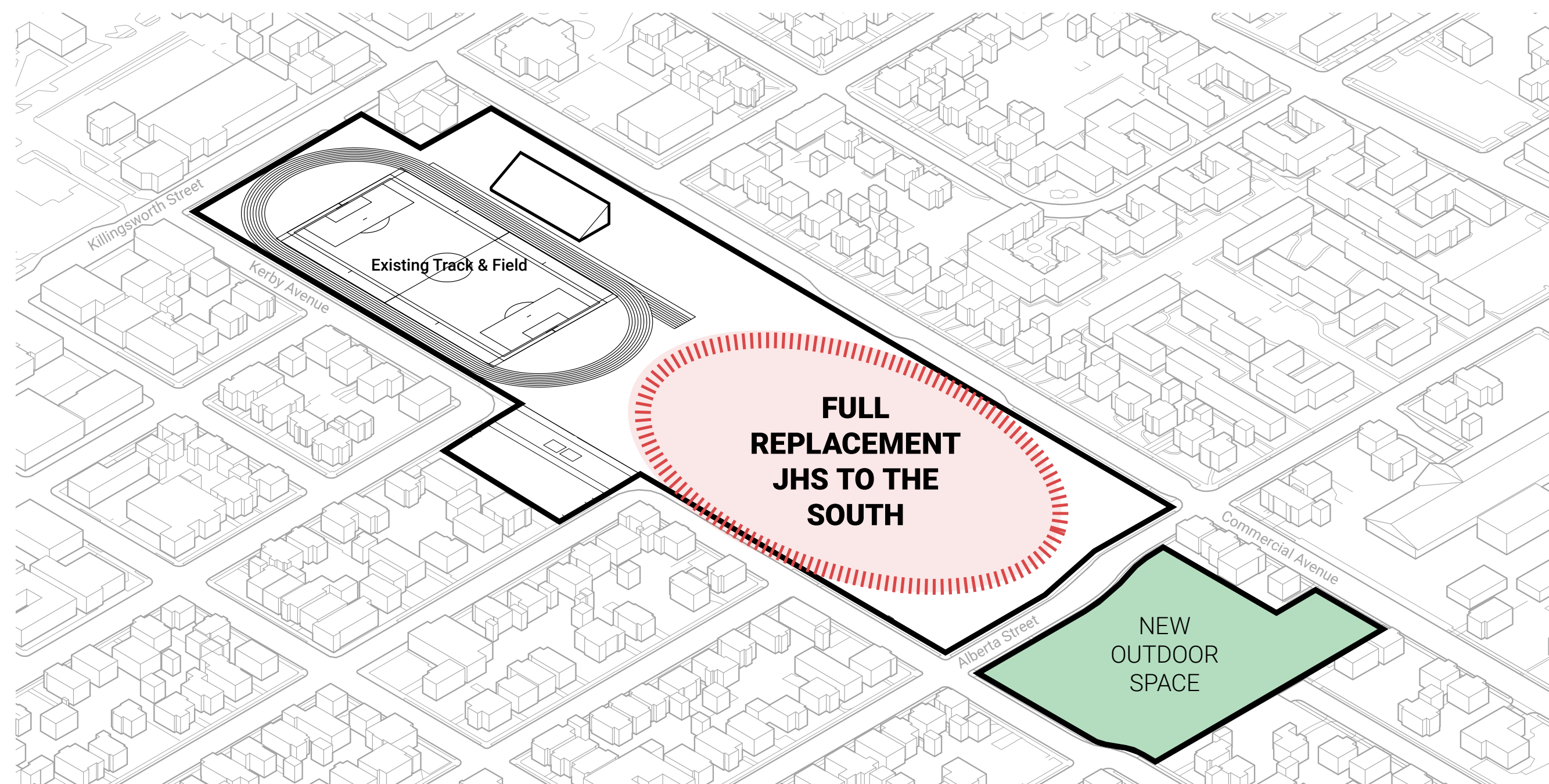

A full replacement building is constructed on the south end of the site. The existing track and field is retained.

Summary:

- Very disruptive to academics and performing arts (students will need to occupy portables and temporary facilities during construction)
- Not very disruptive to athletic spaces (students can remain in existing athletic facilities during construction)
- Fast project delivery timeline
- New construction is less expensive

## SCENARIO 3: MODERNIZATION 1909/1928 & ADDITION

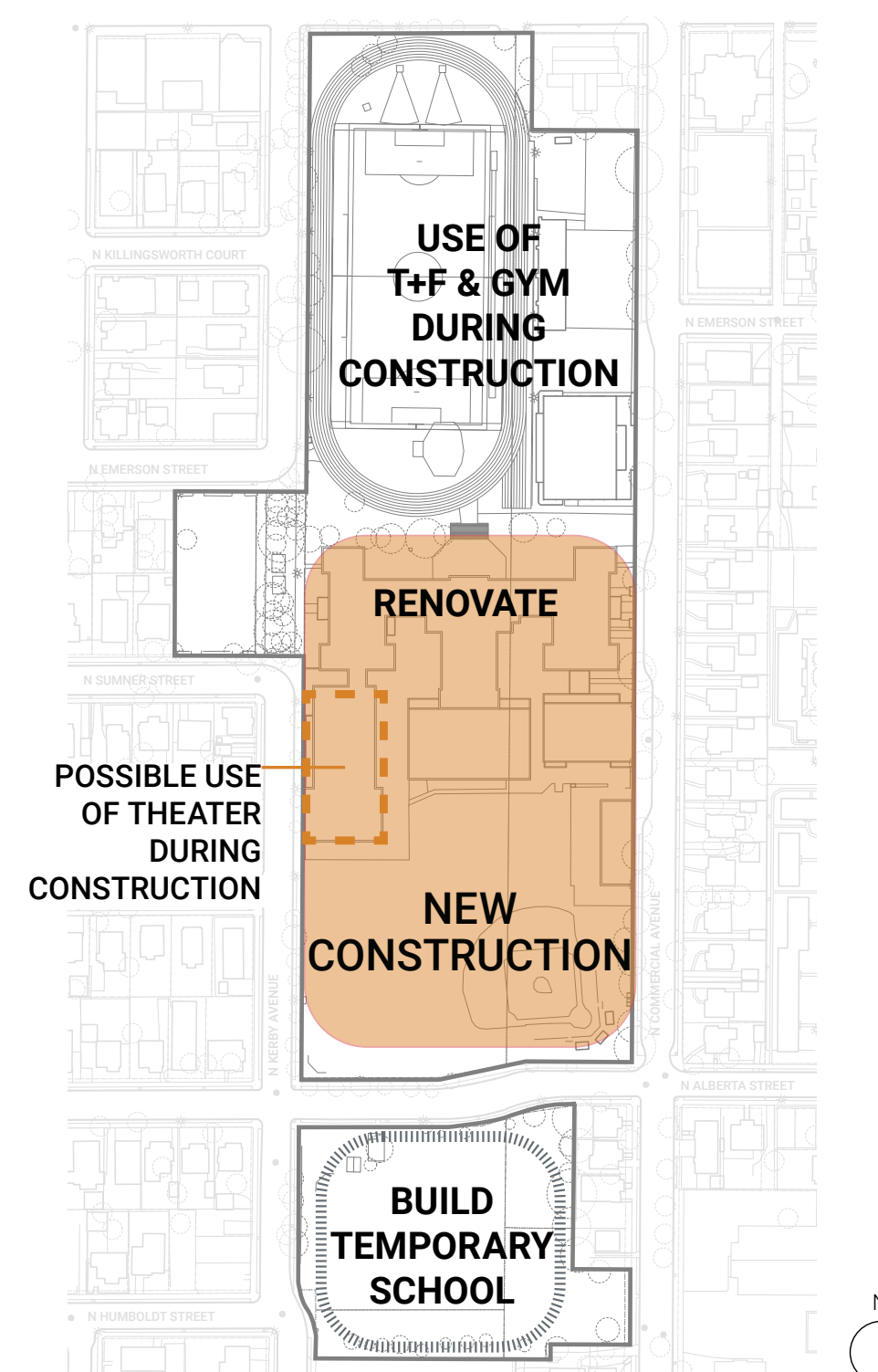
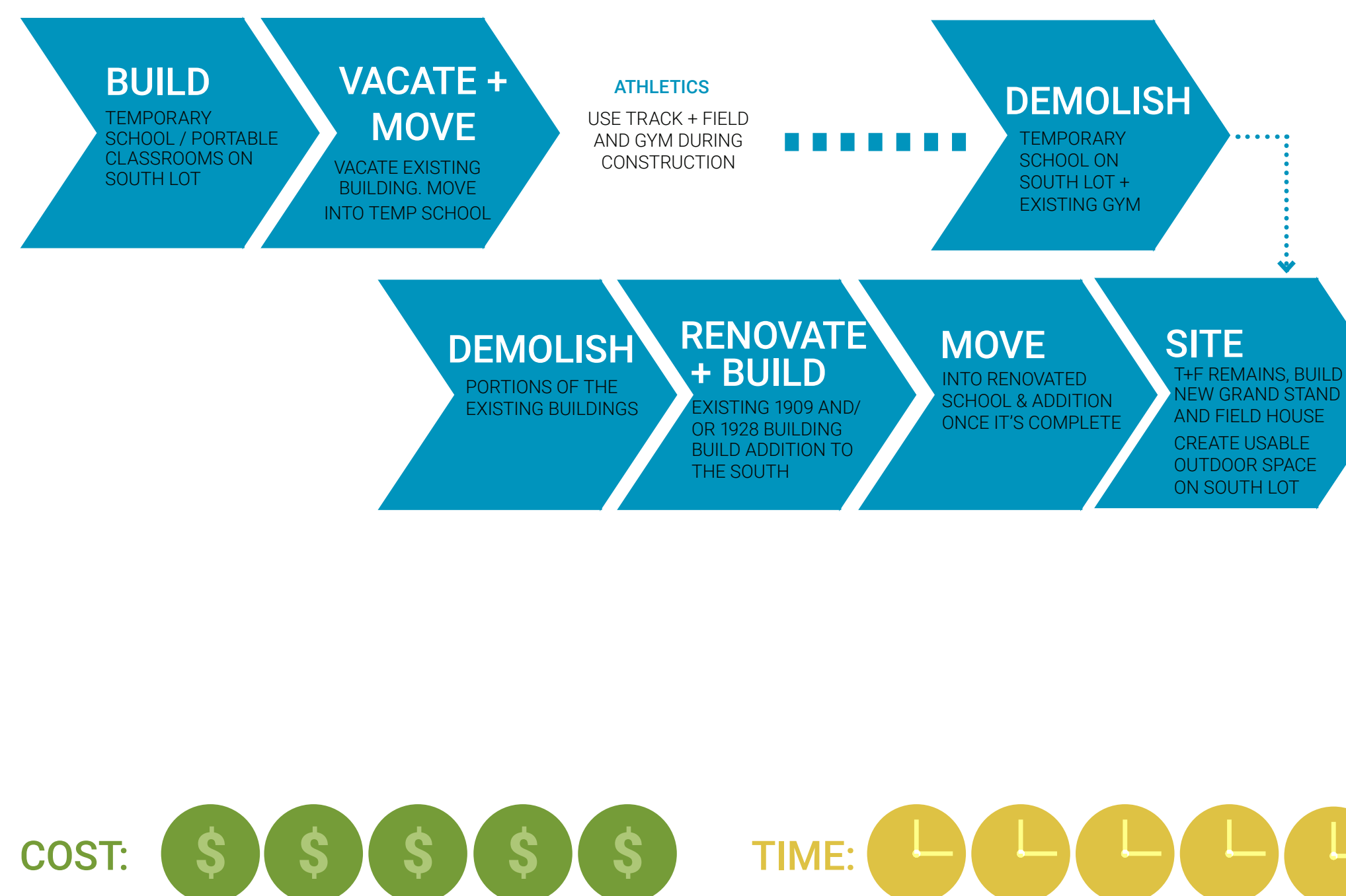
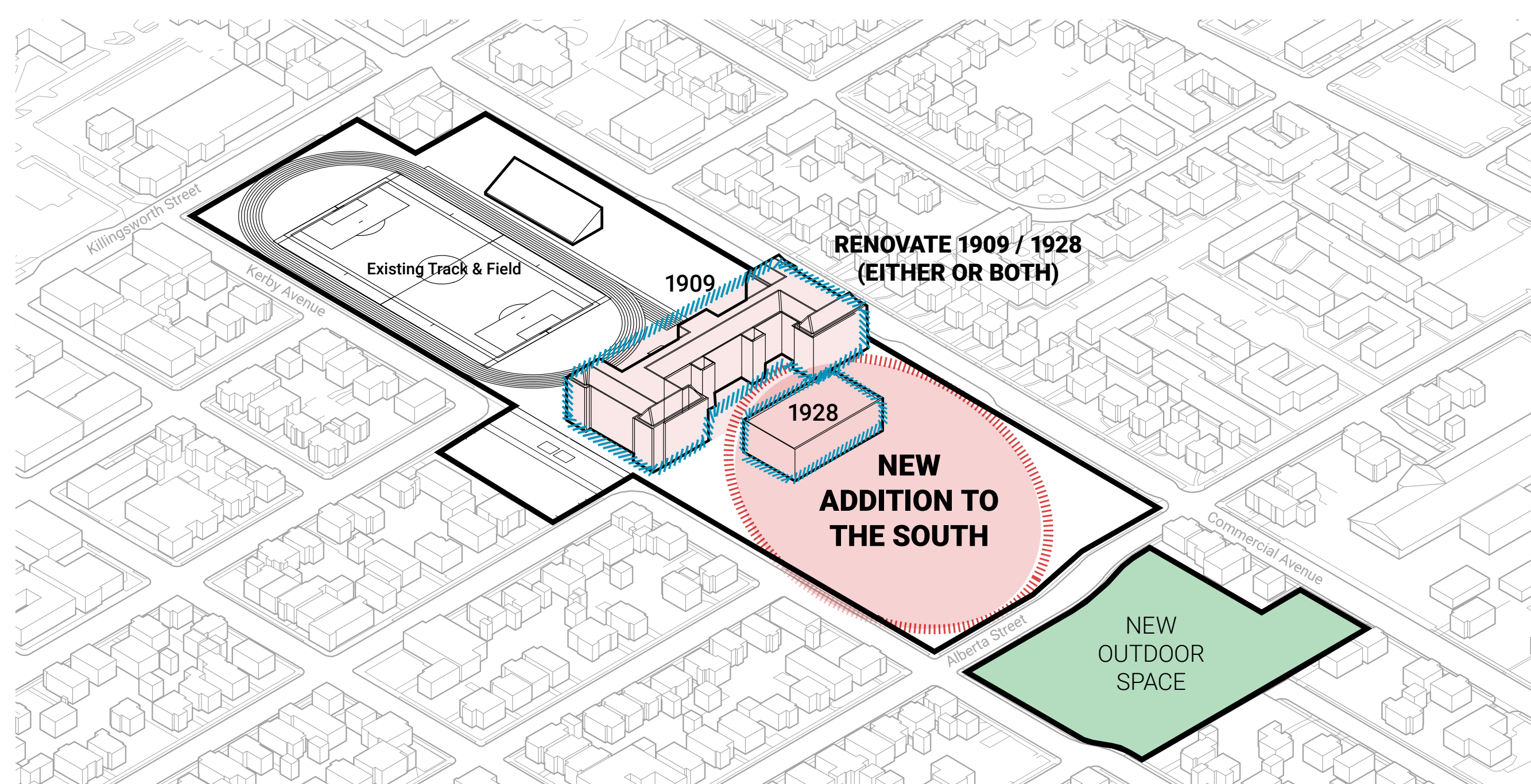

The existing 1909 building and/or 1928 gym is renovated. An addition is built to the south. The existing track and field is retained.

Summary:

- Somewhat disruptive to academics and performing arts (students can occupy a combination of existing JHS spaces, portables, and other temporary facilities until new school in complete)
- Not very disruptive to athletic spaces (students can remain in existing athletic facilities during construction)
- Slowest project delivery timeline
- Renovation is more expensive than new construction